

# PARTS BOOK FOR ULTRASNIC SEALING MACHINE

MODLE: BU3-115W

BU3-115S

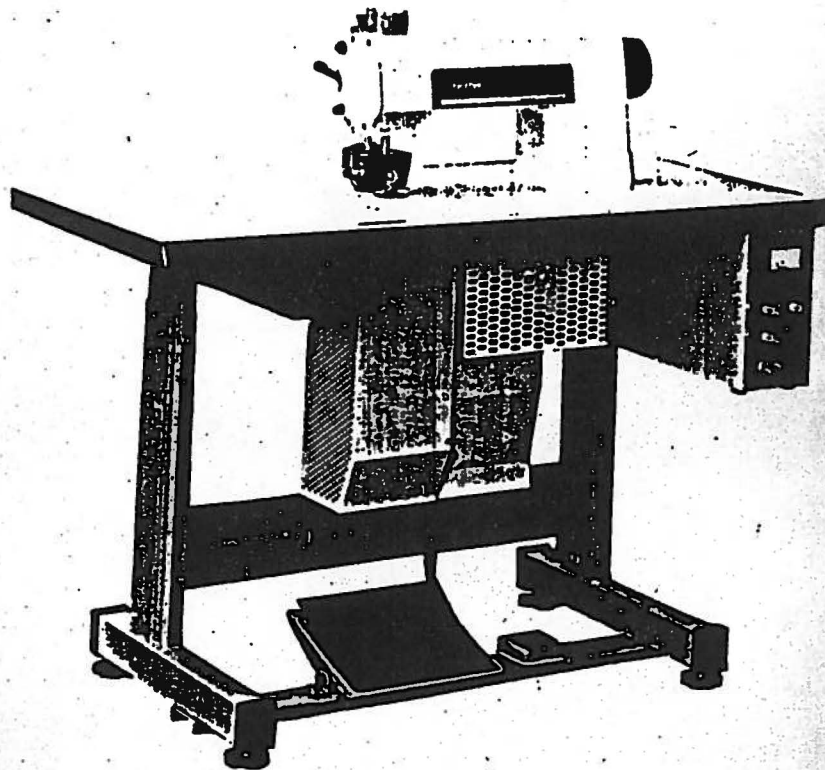

BROTHER INDUSTRIES, LTD

MACHINE TOOL DIV.

From the library of: Superior Sewing Machine & Supply LLC

# BROTHER ULTRASONIC SEALING MACHINE

BU3-115W  
BU3-115S

## TABLE OF CONTENTS

### DRAWING

A. MACHINE BODY (1)	1
B. MACHINE BODY (2)	2
C. DRIVING	3
D. TRANSDUCER	4
E. CONTROL	5
F. LEG AND TREADBOARD	6
G. GENERATOR	7
H. TRANSFORMER	8
I. ACCESSORY	8

### PARTS LIST

A. MACHINE BODY (1)	9
B. MACHINE BODY (2)	9
C. DRIVING	10
D. TRANSDUCER	10 . 11
E. CONTROL	11
F. LEG AND TREADBOARD	11
G. GENERATOR	12
H. TRANSFORMER	12
I. ACCESSORY	12

A. MACHINE BODY (1)

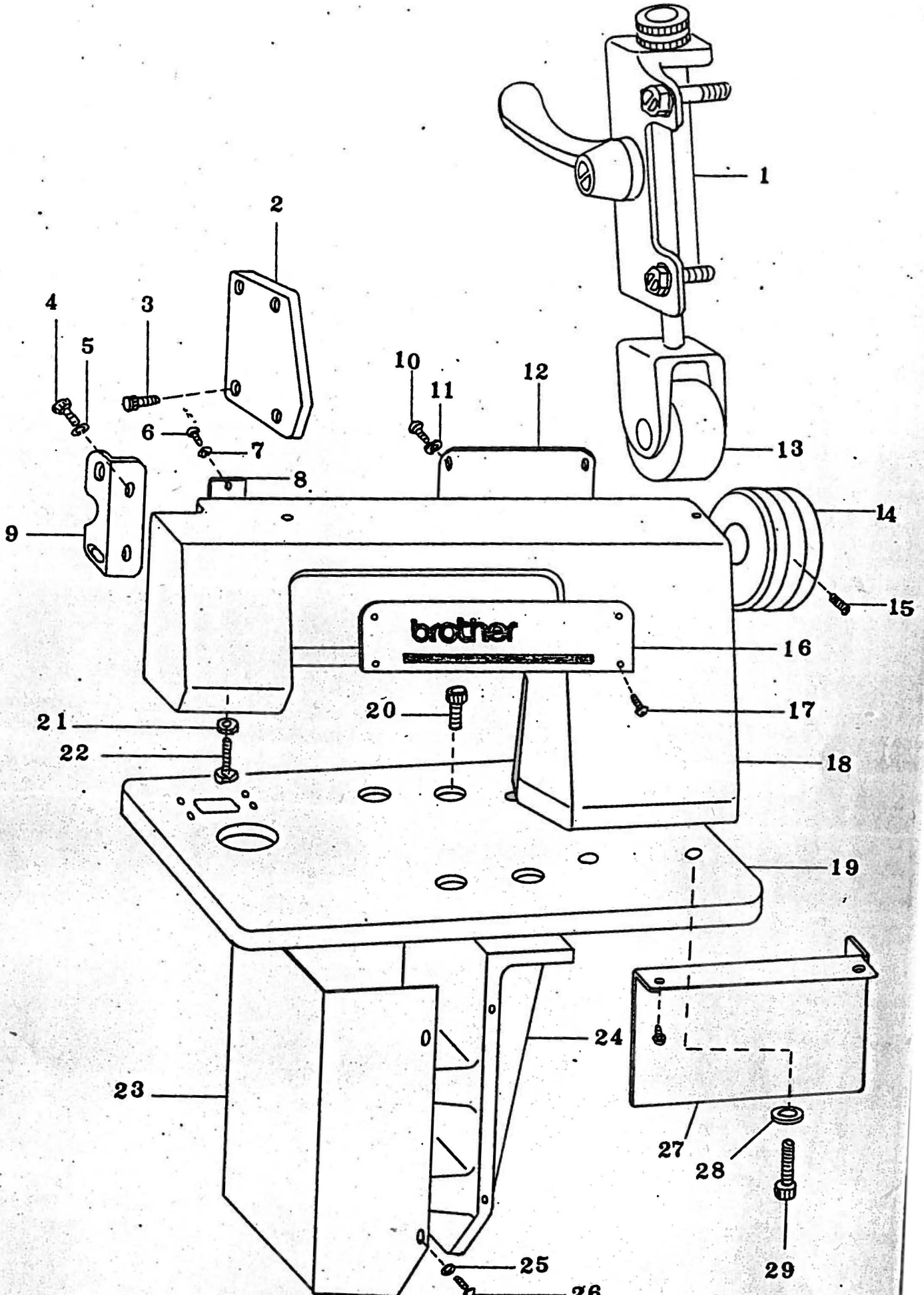

B.MACHINE BODY (2)

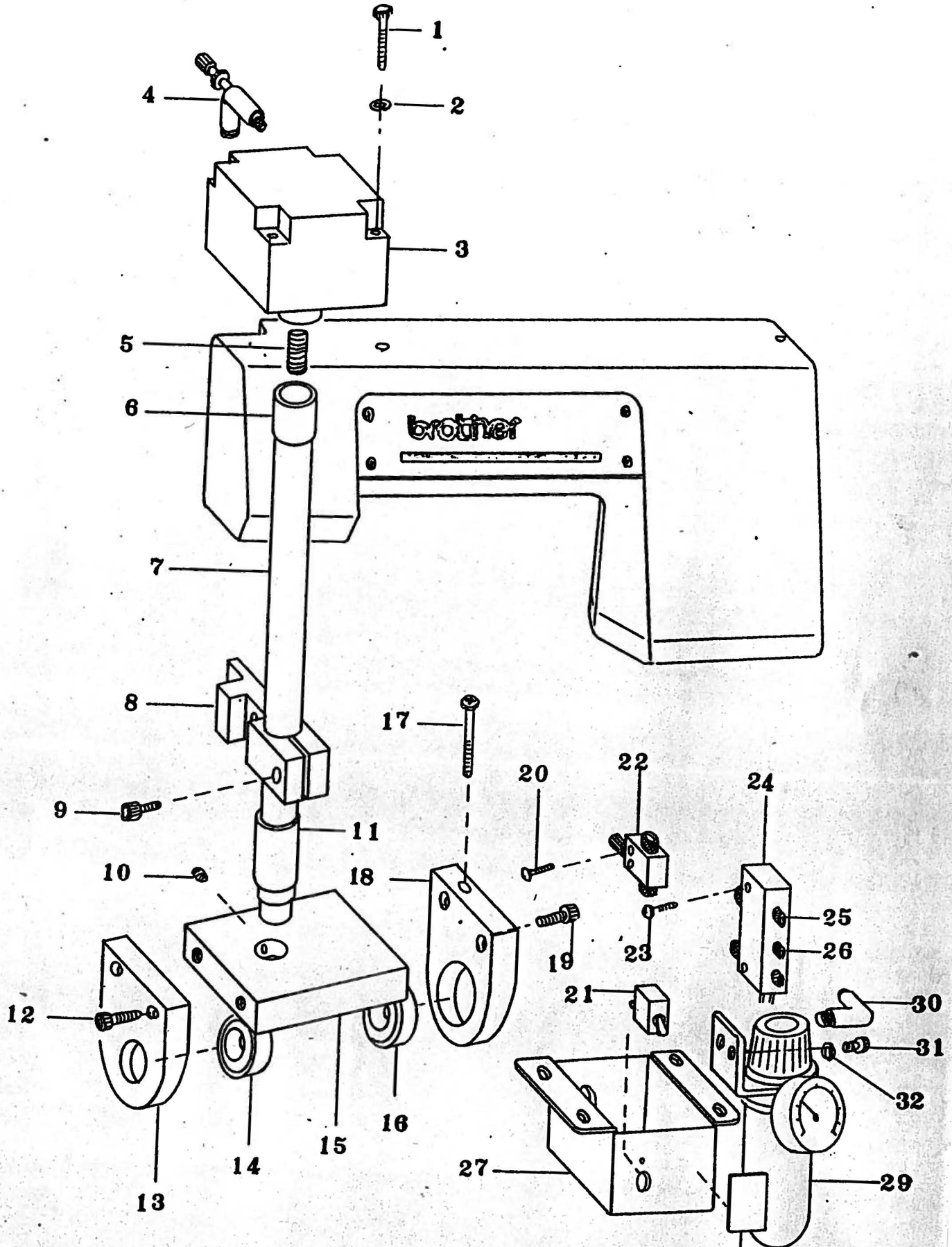

C. DRIVING

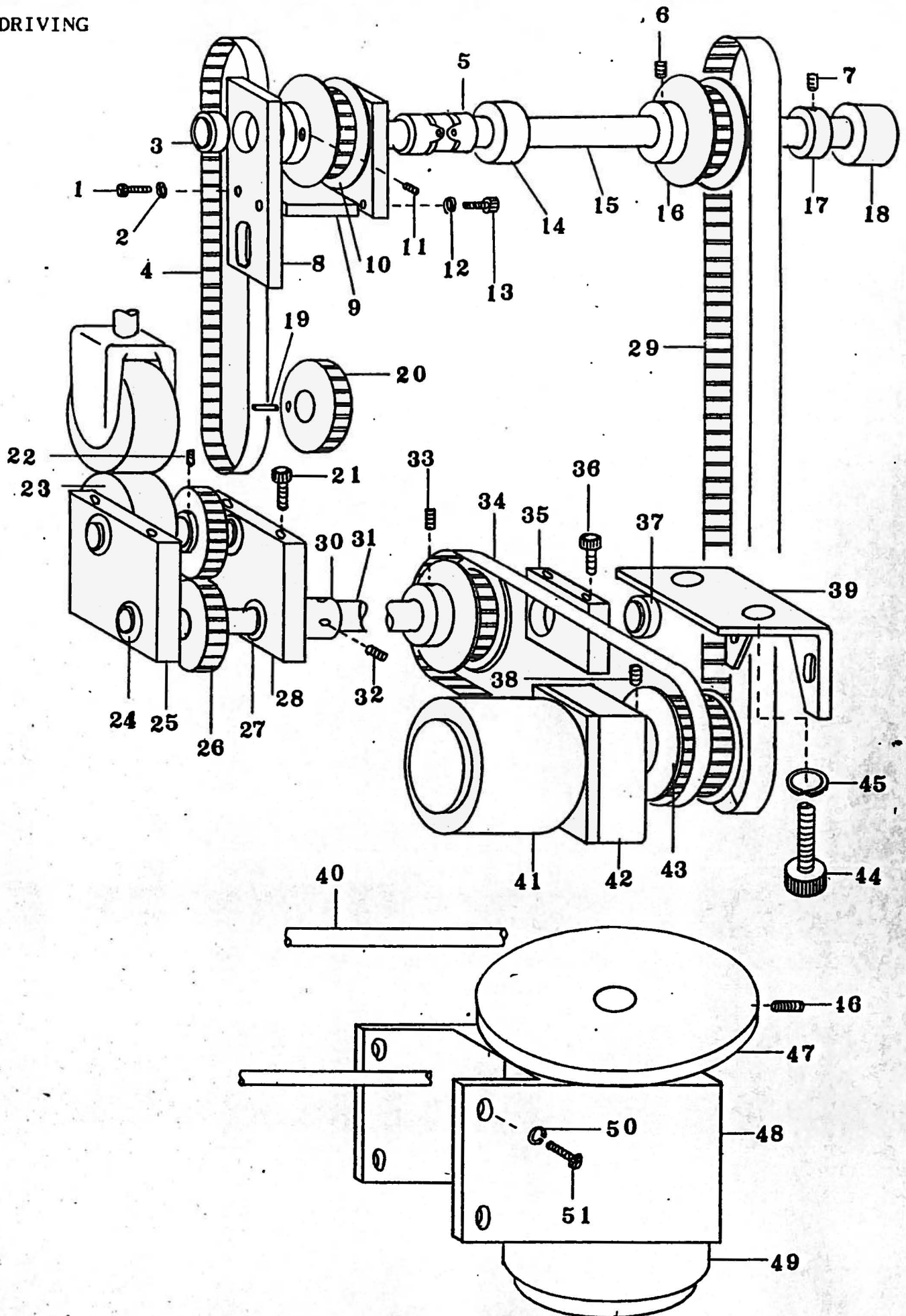

D. TRANSDUCER

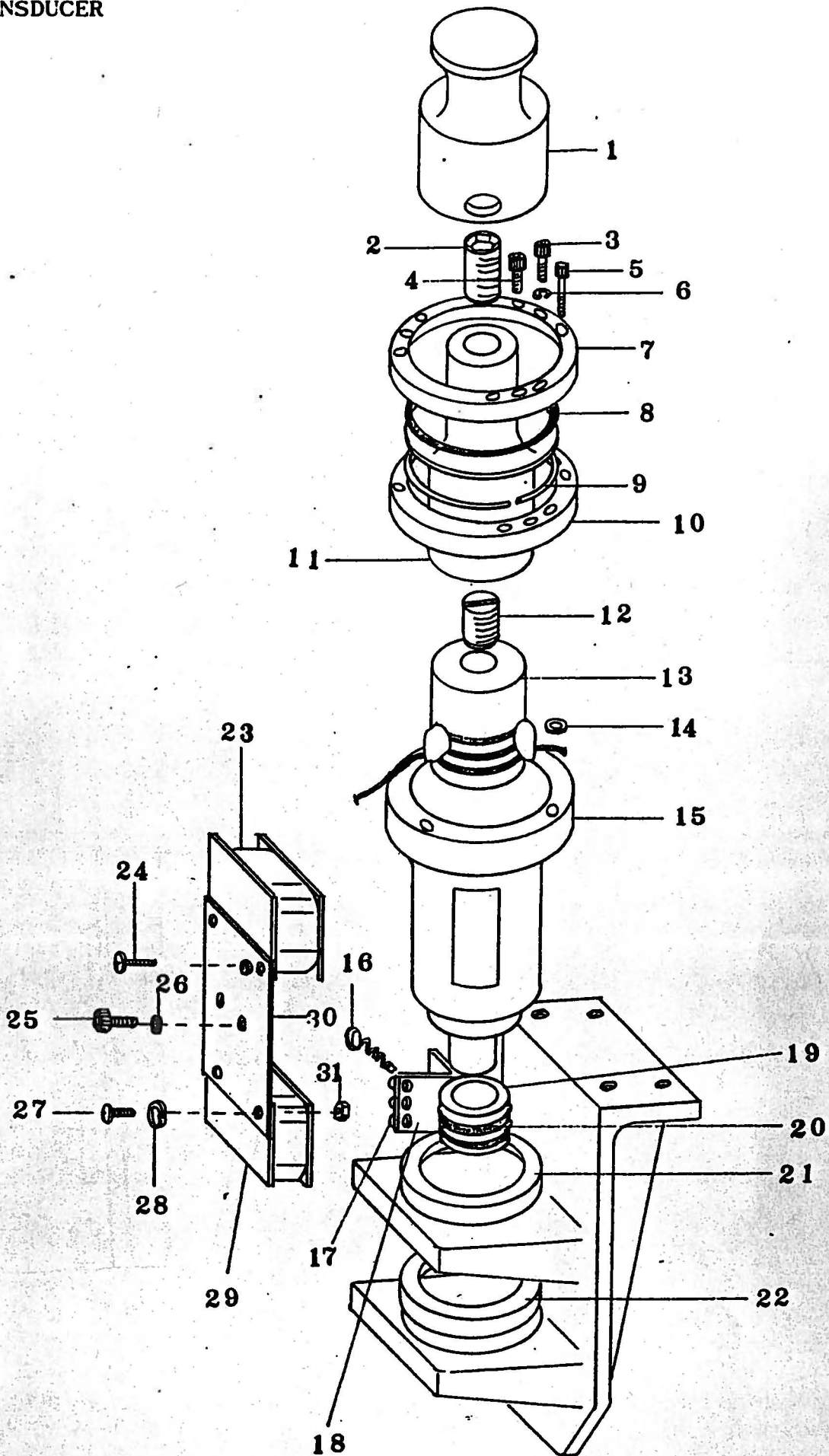

E. CONTROL

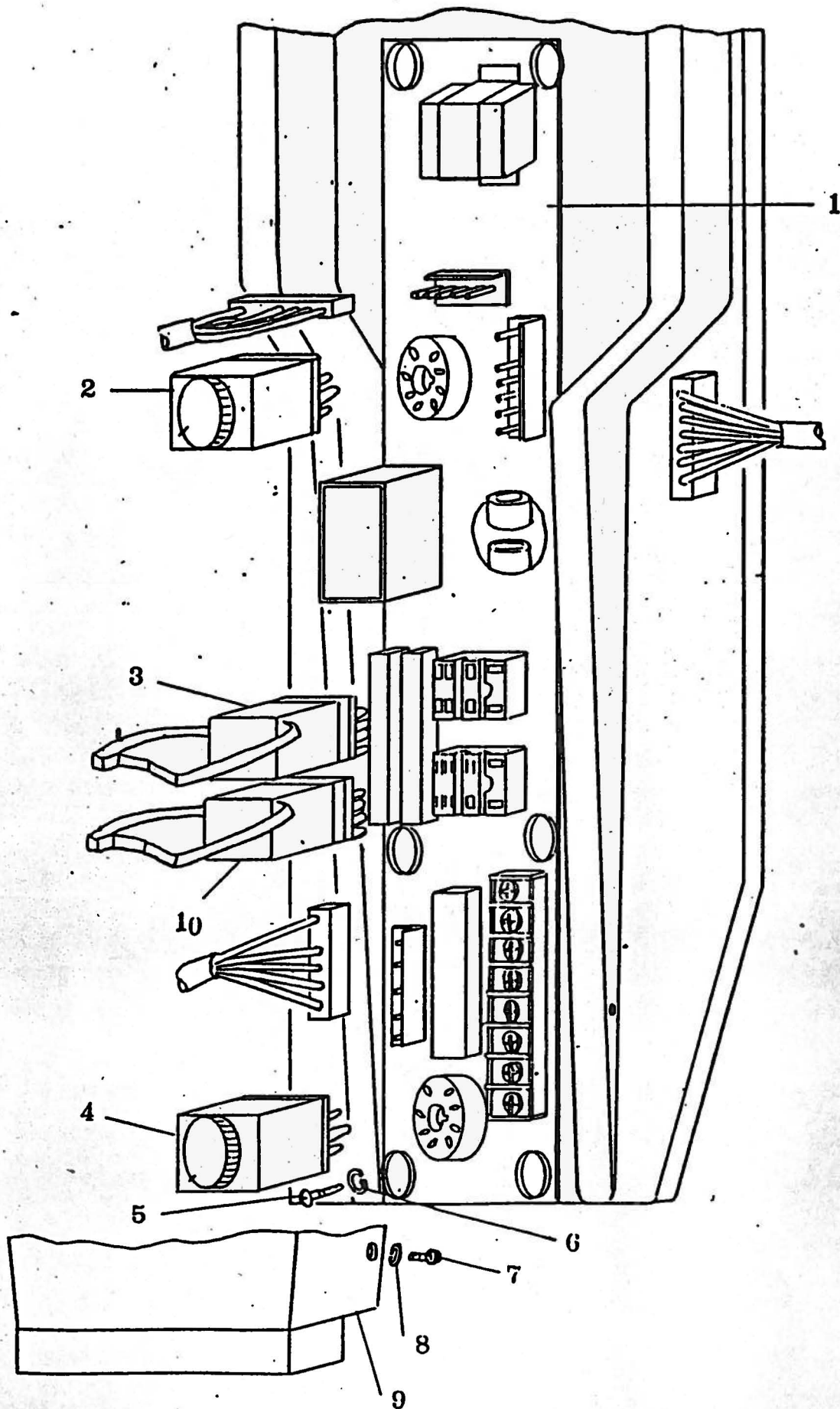

F. LEG AND TREADBOARD

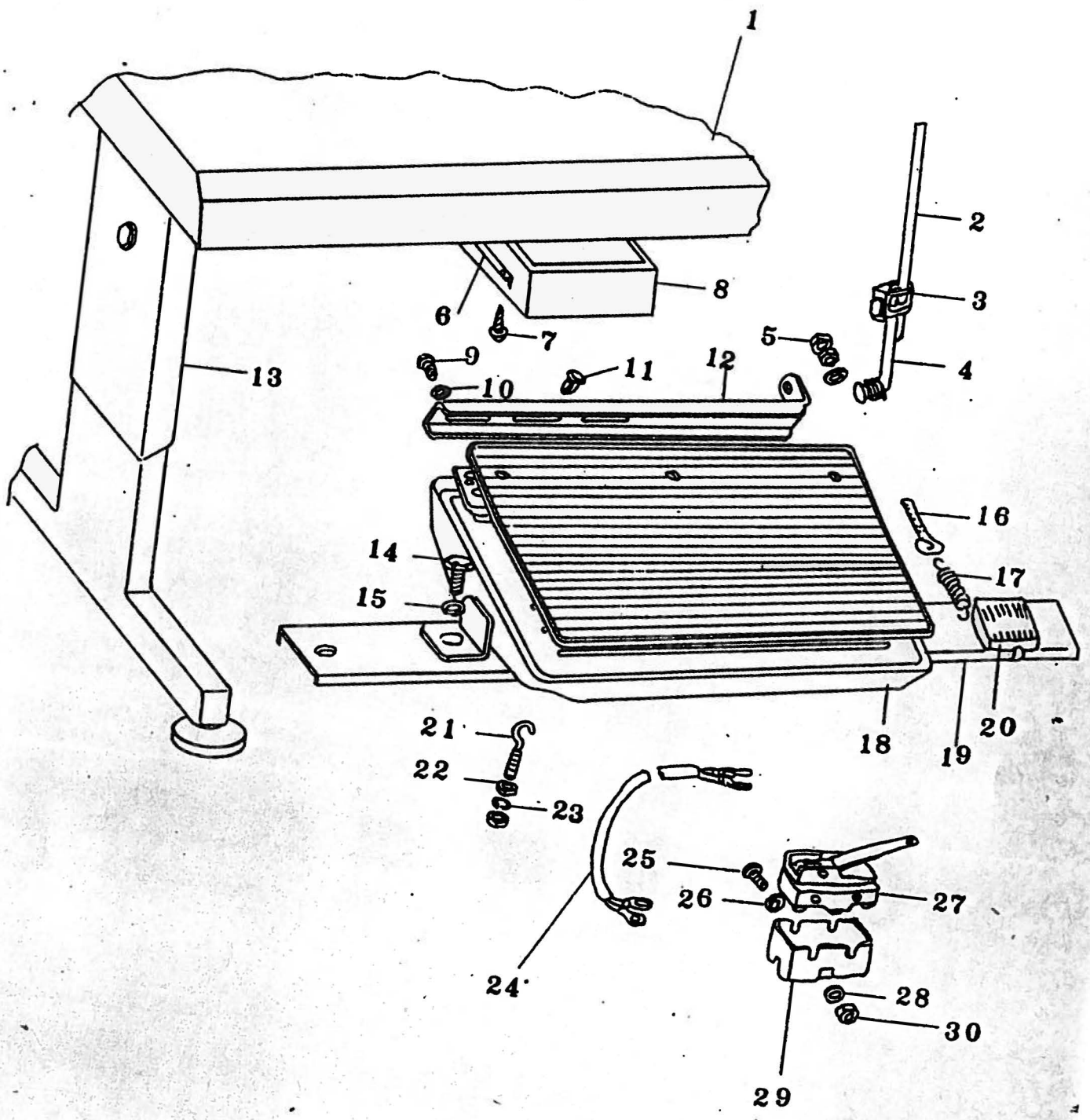



G. GENERATOR.

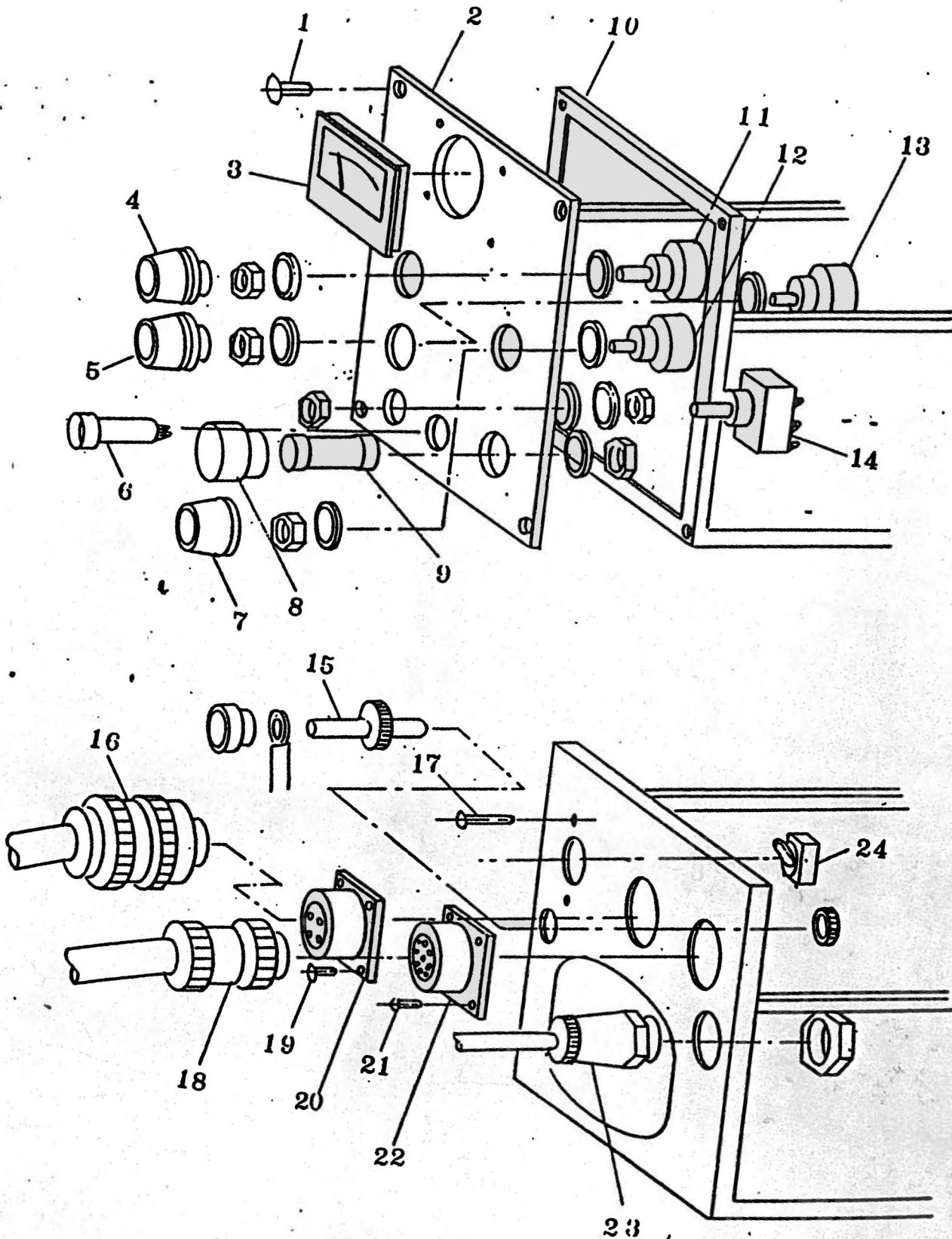

H. TRANSFORMER

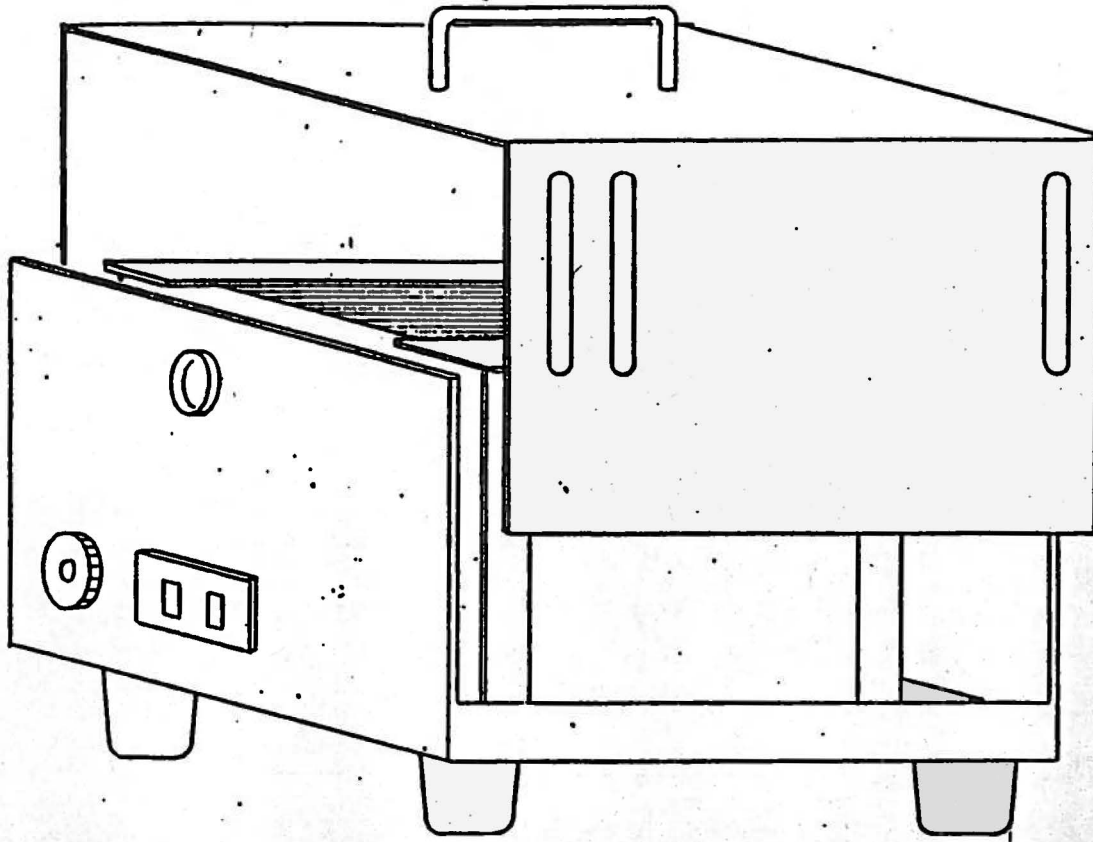

I. ACCESSORY

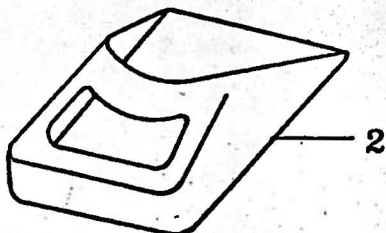
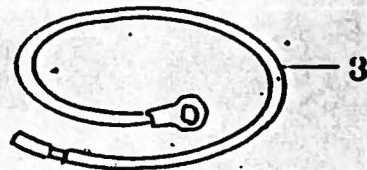

A. Machine Body (1)

No.	Parts Name	Q'ty	Cord	No.	Parts Name	Q'ty	Cord
A- 1	Puller	1	322229010	A-16	Arm Panel 115	1	322230001
2	Face Plate	1	322227000	17			
3	Socket Cap Screw	4	018051222	18	Arm 115	1	322224001
4	Socket Cap Screw	2	018061222	19	Bed 115s	1	322228001
5	Washer	2	028060243	20	Socket Cap Screw	4	018082022
6	Screw	2	002400805	21	Nut		
7	Washer	2	028040243	22		1	
8	Back Caver #1	1	322232001	23	Transducer Cover	1	322175000
9	Puller Holder	1	322138001	24	Fixture	1	338529000
10	Screw	4	002400805	25	Washer	4	028040243
11	Washer	4	028040243	26	Screw	4	002400805
12	Back Cover#1	1	322231001	27	Cover	1	338730000
13				28	Washer	2	025040333
14	Puller	1	115244001	29	Screw 3.5	2	032361306
15	Screw	2	013761410	30			

B. Machine Body (2)

No.	Parts Name	Q'ty	Cord	No.	Parts Name	Q'ty	Cord
B- 1	Socket Cap Screw	4		B-17	Screw	1	002403005
2	Washer	4		18	RollerPlate115W	1	322250001
3	Air Cylinder	1	395663100	"	115s	1	322254001
4	AirFlowContrler2	1	396479100	19	Socket Cap Screw	2	018501222
5	Screw			20	Screws	2	002303005
6	Metal Bush 1222	1	396462100	21	Switch	1	
7	Slide Shaft 115#1	1	322242000	22	AirFlowControler1	1	395670100
8	Bracket	1	322241000	23	Screw	2	002303005
9	Socket Cap Screw	1	018061022	24	Solenoid balve	1	392143100
10	Screw	1		25			
11	Metal Bush 1212	1	396463100	26	Air Fitting	3	392144100
12	Socket Cap Screw	2	018501222	27	Switch Cover	1	322161001
13	RollerPlate 115w	1	322249001	28	Laber	1	322262100
	" 115s	1	322253001	29	Air Clean Uniit	1	395602100
14	Bearing 1201	1	396465100	30	Air Fitting		392277100
	" 108	1	394463100	31	Socket Cap Screw	2	018501222
15	Block 115w	1	322248001	32	Washer	2	028050243
	" 115s	1	322252001	33			
16	Bearing 1201 115w	1	396465100				
	" 108 115s	1	394463100				

C. Driving

No.	Parts Name	Q' ty	Cord	No.	Parts Name	Q' ty	Cord-
C- 1	Socket Cap Screw	2	018041222	C-28	Holder	1	322029000
2	Washer	2	028040243	29	Timing Belt #10	1	395172100
3	Bearing SM08DU3	1	394741100	30	Coupling Ring	1	338716001
4	Timing Belt 85	1	338842000	31	" Shaft	1	322235001
5	Universal Joint	1	392104100	32	Screw	4	012500822
6	Screw	2	012060622	33	"	2	012060622
7	"	2	"	34	Timing Belt 55	1	395061100
8	Pulley Block L115	1	322239001	35	Holder	1	322030001
9	" M115	1	322238001	36	Socket Cap Screw	2	018501222
10	Pulley	1	322010001	37	Bearing SM08DU3	1	394741100
11	Screw	2	012060622	38	Screw	2	012060622
12	Washer	2	028040243	39	Motor Fixture	1	322160000
13	Socket Cap Screw	2	018041222	40	Rope	1	338594000
14	Upper Shaft BushL	1	322037000	41	Motor 60GFV	1	396142100
15	Upper Shaft 115	1	322236000	42	Gear Head	1	396141100
16	Puller	1	322010001	43	Motor Pulley	1	322162000
17	Stop Ling	1	338734001	44	Socket Cap screw	2	018144022
18	Upper Shaft BushR	1	146331001	45	Washer	2	028140243
19	Spring Pin	1	047301247	46	Screw	1	015505212
20	Pulley 115w	1	322258000	47	Drivin Pulley	1	322185000
	" 115s	1	338696000	48	Motor Fixture	1	322164000
21	Socket Cap Screw	4	018501222	49	Motor 90GV	1	396142100
22	Screw	4	012060622	50	Washer	4	028060243
23	Rubber Roller 50	2	322572000	51	Socket Cap Screw	4	018061022
24	Bearing SM08DU3	2	394741100				
25	Holder	1	322029000				
26	Gear	2	338717000				
27	Bearing SM08DU3	1	394741100				

D. Transducer

No.	Parts Name	Q' ty	Cord	No.	Parts Name	Q' ty	Cord-
D- 1	Horn	1	322172000	D- 7	Flange	1	338456001
2	Set Screw	1	391576008	8	O Ring	1	081060790
3	Socket Cap Screw	3	018062022	9	Wire Ring	1	338460000
4	"	3	018063022	10	Flange	1	338455001
5	"	3	018063522	11	Horn	1	338457001
6	Washer	3	028060243	12			

D. Transducer

No.	Parts Name	Q'ty	Cord	No.	Parts Name	Q'ty	Cord
D-13	Transducer	1	338379000	D-25	Socket Cap Screw	2	018061022
14	Washer	3	025040333	26	Washer	2	028060243
15	Transducer Holder	1	322179000	27	Screw	2	002401605
16	Carbon Brush	3	394598100	28	Washer	4	028040243
17	Brush Holder	3	394596100	29	Fan	1	394471100
18	Fitting Plate	1	322173000	30	Fan Fitting Plate	1	322174000
19	Slip Ring	1	394146100	31	Nut	4	021040103
20	O Ring	2	394147100				
21	Bearing 6016zz	1	072601680				
22	" 6017zz	1	072601780				
23	Motor Fan	1	396145100				
24	Screw	2	002401605				

E. Control

No.	Parts Name	Q'ty	Cord	No.	Parts Name	Q'ty	Cord
E- 1	Printed Board	1	322147000	E- 7	Screw	4	002400805
2	Controller	1	399148100	8	Washer	4	028040243
3	Relay	1	398593100	9	Cover	1	322176000
4	Controller	1	399148100	10	Relay	1	398390100
5	Screw	6	002401605				
6	Washer	6	028040243				

F. Leg and Treadboard

No.	Parts Name	Q'ty	Cord	No.	Parts Name	Q'ty	Cord
F- 1	Table 115	1	322255000	F-16	Hook	1	140953000
2	Pedal Fixed Shaft	1	338731000	17	Spring	1	146178001
3				18	Treadboard Ass'ly	1	146175001
4	Lever Shaft	1	133641001	19	Support Plate	1	119704001
5	Nut	2	021060206	20	Foot Switch	1	606370001
6	Box Support	2	101121002	21	Adjusting Hook	1	140947001
7	Screw	4	032361306	22	Nut	2	212251000
8	Table Box	1	119702001	23	Washer	1	028040243
9	Screw	1	001061606	24	U2 Cord Ass'ly	1	146160001
10	Washer	1	025066200	25	Screw	2	002405005
11				26	Washer	2	028040243
12	Fitting Arm	1	133635001	27	Switch	2	140948001
13	Outer Leg	1	133625001	28	Washer	2	028040243
14	Bolt	2	017061206	29	Switch Cover	2	396047000
15	Washer	2	025060243	30	Nut	2	021046103

G. Generator

No.	Parts Name	Q'ty	Cord	No.	Parts Name	Q'ty	Cord
G- 1	Screw	4	008400503	G-14	Snap Switch	1	398622100
2	Front Panel	1	322145000	15	Earth Terminal	1	321300019
3	Ampere Meter	1	399142100	16	Output Cable	1	322148000
4	Knob	1	398330100	17	Screw	2	002300603
5	"	1	"	18	Signal	1	322149000
6	Neon Bracket	1	398084100	19	Screw	4	002300803
7	Knob	1	398330100	20	ConnectorReceptacle	1	398799000
8	Fuse Holder	1	398720001	21	Screw	4	002300803
9	15A Fuse	1	398721001	22	Receptacle	1	398432100
10	Chassis	1	338736000	23	Cord Lock	1	399927000
11	Resistor 20K $\Omega$	1	398294100	24	CircuitProtector	1	399144100
12	" 2K $\Omega$	1	398637100				
13	" 20K $\Omega$	1	398294100				

H. Transformer

No.	Parts Name	Q'ty	Cord	No.	Parts Name	Q'ty	Cord
H- 1	1.5KVA Trans Unit	1					

I. Accessory

No.	Parts Name	Q'ty	Cord	No.	Parts Name	Q'ty	Cord
I- 1	Hexagon Wrench	1	602776001				
2	Rubber Leg	1	133632001				
3	Earth Wire	1	301162000				
4	Fuse	2	398651100				
5	"	2	398340100				
6							